

SOLFIL[®] +

Range

exclusive system
Patented
without the need for prior
preparation of the
equipotential bonding
cable



A range of insulation
displacement connectors
for equipotential bonding





Patented insulation displacement connector

The **SOLFIL®+** range of connectors offer a convenient solution to most of installation requirements without the need for prior preparation of the equipotential bonding cable.

A simple powered screwdriver is the only tool required.

The **SOLFIL®+** range meets the requirements of UL 1703 and UTE C15-712 standards.



An electrical contact of quality

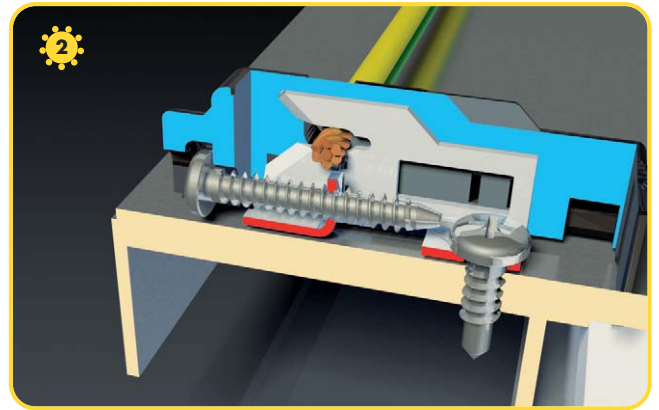
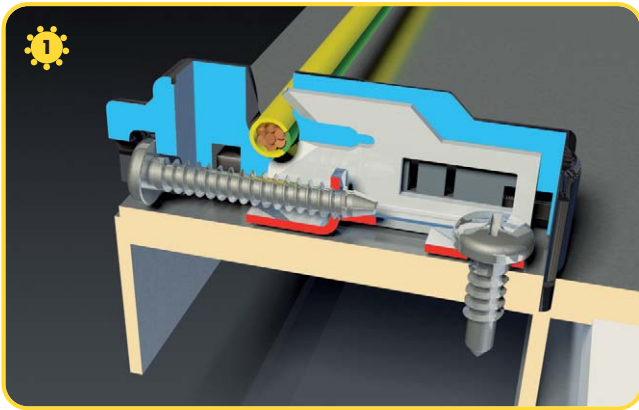

The equipotential bonding of photovoltaic panels is provided:

- 1** by tapping thanks to the thread pattern of the stainless steel fixing screw, which creates the contact with the aluminium frame.
- 2** thanks to the 2 stainless steel blades which cut and displace the cable insulation, a reliable contact is made with the conductor.

This technology achieves a contact of excellent quality, even the difficulty of an anodized surface on the panel does not present a problem.

This **SOLFIL®+** technology allows an individual frame to be disconnected without lessening the integrity of the connections to the other frames or the equipotential bond connecting them.



Example of a quick and reliable implementation of SOLFIL®+



Solfil+ can be fixed quickly by drilling and tapping the chassis, using a screwdriver equipped with a PZ2 hexagon bit.

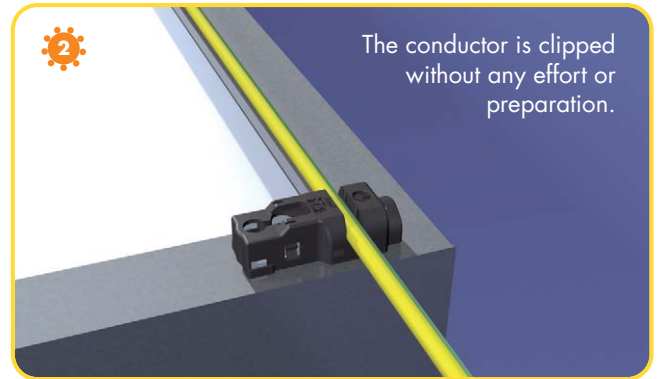

The conductor is clipped without any effort or preparation.

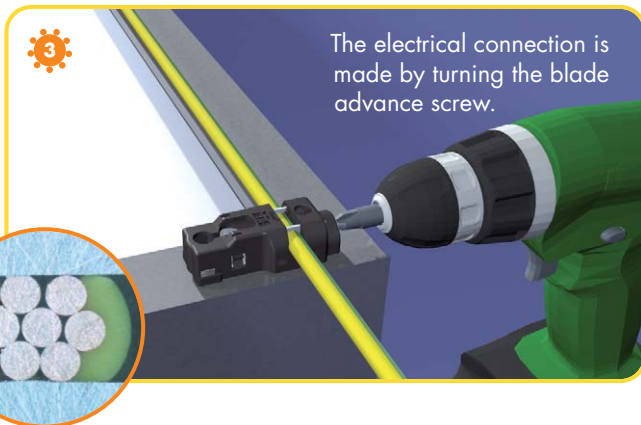

The electrical connection is made by turning the blade advance screw.

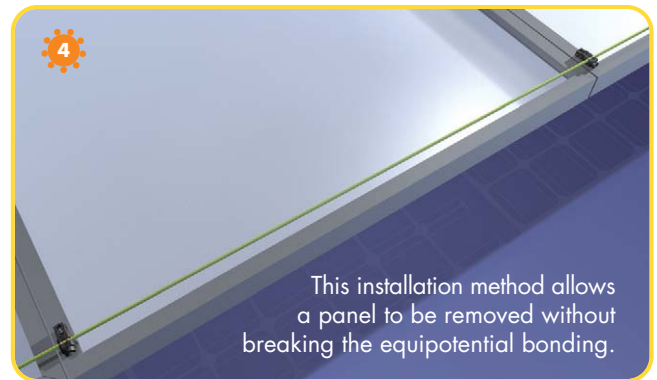

This installation method allows a panel to be removed without breaking the equipotential bonding.

A range which can be adapted to all the situations

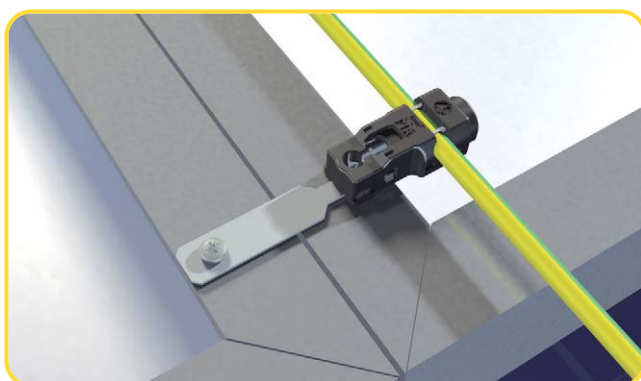

SFP6PI2V
2-panel bonding

It enables to connect directly 2 panels side by side when it is possible to have an access under the modules as for the installations on the ground.



SFP6PIPR
with ductile extender

It allows some flexibility in the positioning even when the access and space requirements could imply a difficult mounting. After fixing, the operator can easily adjust the extender to operate the connection.



Characteristics

- Thickness of the chassis for fixing/drilling: 1.2 to 2 mm in aluminium only.
- Recommended cable:

6 mm ² *	Type	Colour	Quality	Nbr of strands
	insulated H07	green/yellow	Rigid	7

* according to the requirements of UTE C 15-712 standard



Side-face views
(dimensions in mm)

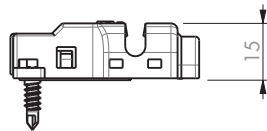

Top views
(dimensions in mm)

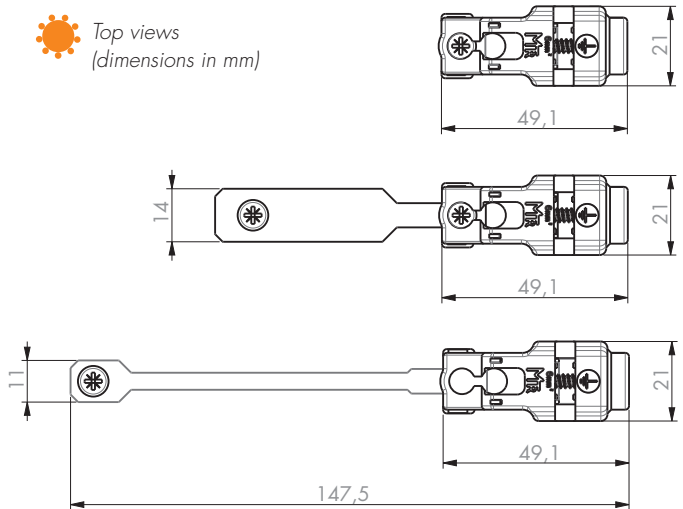

Part number table

Product	Item code	Part number	Material	Packing
	7341960	SFP6PI	Stainless steel	100
	7341966	SFP6PI2V	Stainless steel	50
	7341971	SFP6PIPR	Stainless steel	50

Tooling for connector

Product	Item code	Part number
<ul style="list-style-type: none"> • Professional cordless screwdriver. • Lithium-Ion battery: 10.8 V – 1.3 Ah. • Load indicator. • 10 mm self-locking chuck. • Max. torque: 30 Nm. • Delivered in a box with 2 batteries and 1 charger. • Cordless screwdriver: weight 0.95 kg – length 179 mm. 	7512070	GSR10,8-2Li

Distributed by: